

NCVIEW 2018

NCVIEW Neo 2018

NCVIEW / NCVIEW Neo 2018 Release Notes

- A) New Feature Overview
- B) Main Improvements and Modifications (Improvements and modifications after release of NCVIEW / NCVIEW Neo 2017 are listed.)
- C) List of Support Reception Numbers
- D) Operating Environment

The numbers listed in parentheses () in the descriptions below are Support Reception Numbers. See the Previously reported Support responses.

Marks indicate supported modules.

Neo : NCVIEW Neo、 **SOLID** : NCVIEW SOLIDwatch、 **MULTAX** : NCVIEW MULTAXwatch、
TURN : NCVIEW TURNwatch、 **TOOL** : NCVIEW TOOLwatch

A) New Features Overview

1. Expanded the tool length optimization. **Neo**
 - Expand to optimize the tool length in consideration of Jig.

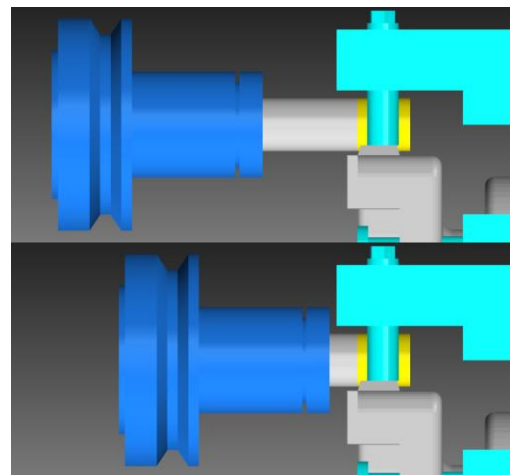
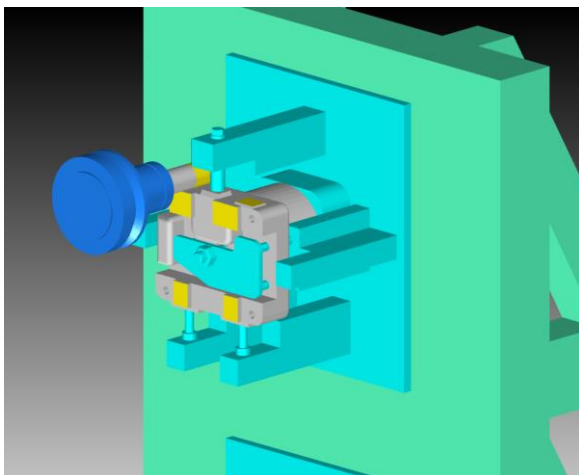

2. Expanded the movement of the slant rotating axis.

Simulation for the machine which has the slanted rotating axis is expanded.

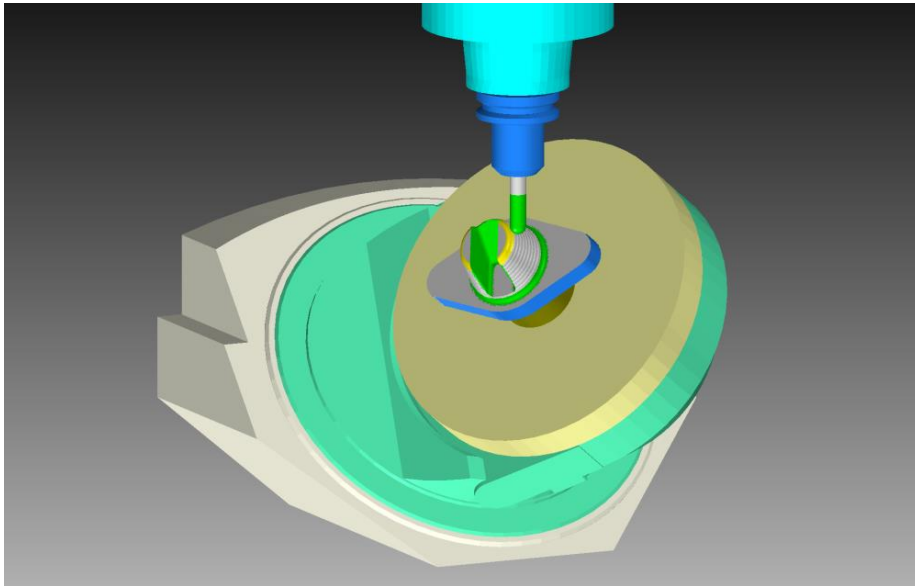

3. Expanded and improved the Drilling report function.

The drill check function is expanded to perform the drilling inspection easily.

- Expanded the coordinate value display of the report output
- Regulated the report output order in processing order
- Regulated the drilling direction of the report output

4. Expanded the model comparison function. Neo

- Improved judgement precision of overcut and uncut
- Modified output message after Model comparison

5. Expanded the workpiece recorder (workpiece auto-save) function. Neo SOLID MULTAX

- The workpiece can be automatically saved when main program is finished.

6. Added to support OSP WHILE, DO, END macro command.

7. Added to support MULTUS TD command for Tool change.

8. Added to support FANUC Drill cycle for lathe. (201205006)

The following machine command is added. Please refer to NCVIEW Help for the command.

L_CYCLE83 *G code*

L_CYCLE84 *G code*

L_CYCLE85 *G code*

L_CYCLE86 *G code*

L_CYCLE87 *G code*

L_CYCLE88 *G code*

L_CYCLE89 *G code*

L_DRILLCYCLE_DWELL *Dwell time*

9. Added to support to specify the return point for the fixed cycle for lathe. (201505004)

The following machine command is added. Please refer to NCVIEW Help for the command.

NC_PARAM TCRP

B) Main Improvements and Modifications

- Fixed the shape of the taper tool and the ball taper tool. (201704006)
- Fixed Lathe offset system variables on FANUC.
- Fixed required tool length in Milling tool settings.
- Fixed measurement result of arc. (201612016, 201705011)
- Fixed tool diameter path view filtering. (201705004)
- Fixed a problem when using FANUC PCODE variables. (201705007, 201705011)
- Fixed DXF file input of user defined tool. (201705008)
- Fixed mouse pointer behavior on message dialog. (201705003)
- Fixed action after the machine coordinate system.
- Fixed the collision detection of the workpiece and the attachment, VM machine parts. **Neo**
- Fixed motion after tool position compensation. (201612017)
- Added setting to cancel tool position compensation during return reference point. (201705012)
- Fixed user defined drilling type interference check function. (201707002)
- Fixed skip operation. (201707003) **Neo**
- Fixed motion of lathe complex fixed cycle during nose R compensation. (201702008)
- Fix to include attachment shape file during ZIP compression.
- Fixed to edit the NC data including the fullwidth character.
- Fixed to read the unjust NC data.
- Improved the message indication contents during tool diameter compensation.

- Improved the operation for setting all breakpoints.
- Improved the processing time of several fixed cycle. (201703005)
- Improved continuous pick function. **TOOL**
- Improved detailed view of displaying XY-plane. **Neo**
- Improved the bookmark function for NC data display.
- Improved the collision detection of the arc interpolation. **TURN**
- Improved the cutting history report when using the batch function. (201706005)
- Adjusted NRC parameter of the cycle for lathe.
- Adjusted not to fail the acquisition of local license in Windows10.
- Adjusted other details and the malfunction.

C) List of Support Reception Numbers

201205006、 201505004、 201612016、 201612017、 201702008、 201704006、 201705003、
201705004、 201705007
201705008、 201705011、 201705012、 201706005、 201707002、 201707003

D) Operating Environment

OS	<p>< NCVIEW / NCVIEW Neo 32-bit Version > Windows 10 / Windows 10 64bit Windows 8.1 / Windows 8.1 64bit Windows 7 / Windows 7 64bit ※Also operates on 32-bit if installed on a 64-bit OS.</p> <p>< NCVIEW Neo 64-bit Version > Windows 10 64bit Windows 8.1 64bit Windows 7 64bit</p>
Memory	1GB or higher recommended
CPU	Multi-core recommended
Graphics	NVIDIA recommended

Copyright (c) 2018 Cimple Technology Inc. All rights reserved.